



WARMOTECH 550

window assembly systems
multi-layer elements
w-core panels





COMPANY

In Europe a growing number of companies are entering the circular economy with sustainable production models, recycling construction waste that normally ends up in landfills. One of these companies is the Lithuanian company UAB ANDERUS. The company recycles rigid polyurethane foam waste to produce construction panels under the Warmotech brand, a material that meets high mechanical standards and has exceptional properties. UAB ANDERUS can offer solutions and products that are both efficient and environmentally conscious.

QUALITY

Issued European Technical Assessment (ETA-22/0454) demonstrates our commitment to quality and safety standards. Warmotech boards are compliant with the relevant EU regulations and also has Environmental Product Declaration. The verifications and assessment methods lead to the assumption of working life of the thermal insulation boards of at least 25 years. In addition, Warmotech panels are a low-emission material (formaldehyde-free) that conforms to the M1 emission class.



PRODUCTS

Warmotech boards are intended to be used as thermal insulation in buildings and construction applications, including floors, walls and roofs. Warmotech panels are widely used in the construction sector for building units where the problem of thermal bridges may occur or by replacing other insulating materials that are not strong enough to withstand heavy loads. Products made of Warmotech boards are widely used for installing windows and doors in the insulation layer.

Warmotech boards are composed of milled PU-residues (can include other materials e.g., craft paper or aluminum foil) and bonding agents. The final product – Warmotech board – is made of at least 90% recycled rigid polyurethane (PU) foam. The residue left after cutting/ processing the board can be milled and reused once more.





WARMOTECH 550

Warmotech is a recycled PU foam board, with a density of 550 kg/m³. Warmotech boards can be painted, laminated, combined with other materials to create new products for various applications. It is easily fixed by conventional fixing methods, i.e. using screws or adhesives. The color of Warmotech boards (green or yellow) depends on the origins of the recycled polyurethane. However, it has no effect on the flammability, mechanical strength, thermal conductivity and other declared characteristics.



green



yellow

PRODUCT DATA SHEET

Essential characteristic	Test method	Unit	Performance and characteristics	Standard formats
Reaction to fire	EN 13501-1:2019		D-s3, d0	
Bending strength	EN 12089:2013	MPa	≥ 4,7	
Thermal conductivity, λ _{D(23/50)}	EN 12667:2002	W/ (m·K)	≤ 0,088	
Compressive strength	EN 826:2013	MPa	≥ 7,1 ⁴⁾	
Water absorption (by short term, partial immersion)	EN ISO 29767	kg/m²	≤ 0,4	
Dimensional stability under specified temperature and humidity (DS 70,90)	EN 1604:2013	%	≤ 1,0	
Dimensional stability under specified temperature and humidity (DS -20,-)	EN 1604:2013	%	≤ 1,0	
Density	EN 1602:2013	kg/m³	550 ± 50	
Nominal thickness	EN 823:2013	mm	0.5	20, 30, 40, 50, 60, 70 ²⁾
Nominal length	EN 822:2013	mm	5.0	2750, 3020, 3600 ³⁾
Nominal width	EN 822:2013	mm	5.0	1150, 1220 ³⁾
Squareness	EN 824:2013	mm/m	1.0	
Flatness	EN 825:2013	mm	4.0	
Hygroscopic sorption properties ¹⁾	EN ISO 12571	%	≤ 3,0	
Water vapour diffusion resistance coefficient ¹⁾	EN 12086:2013	μ	25-90	

1) Laboratory values, not declared in DOP and ETA.

2) Other thicknesses on request.

Thickness range from 10 mm to 100 mm.

3) Standard panel formats:

1150 x 2750 mm, 1220 x 3020 mm, 1220 x 3600 mm.

4) Valid for thicknesses up to 60 mm.



European technical assesment (ETA)



Declaration of performance (DOP)



Environmental product declaration (EPD)



PRO 80/ PRO 90 system

Warmotech **PRO 80 / 90 system** is used as a frame system for window installation in the thermal insulation layer. The profiles are made of a solid layer of Warmotech material for durability, dimensional stability, compressive strength and soundproofing characteristics.

Additional layer of extruded polystyrene on the outside provides additional thermal insulation properties. Profiles are sold in units, standard unit length - 1150 mm or 2750 mm.

< 1,0 %
Dimensional stability

0,77 W/m²K
U Value, from

2750 mm
Long elements, up to

100 kg
Load point, from

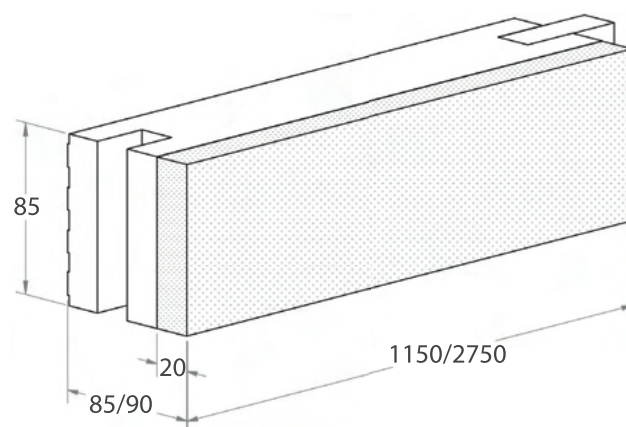
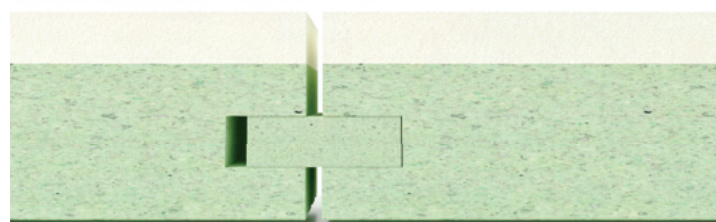

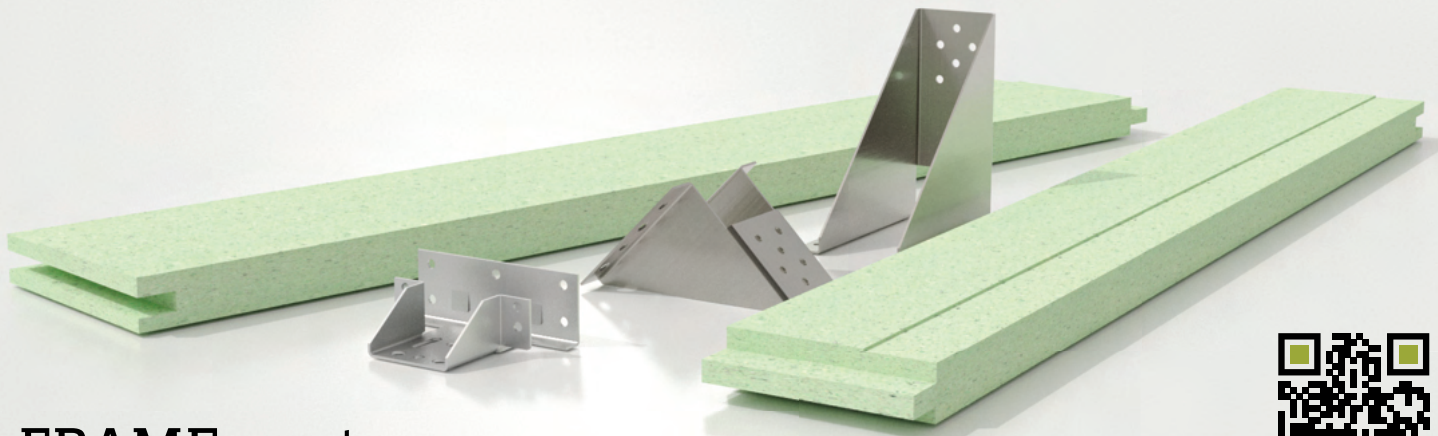

M FRAME system

Warmotech **M FRAME system** is used for window installation in the thermal insulation layer. Specifically made to create a wider inner windowsill. The profiles are made of a solid Warmotech material for durability, dimensional stability, compressive strength and soundproofing characteristics. System consists of stainless steel mounting brackets and holders. M FRAME system can also be installed at sub-zero temperatures.

Profiles are sold in units, standard unit length - 2750 mm.

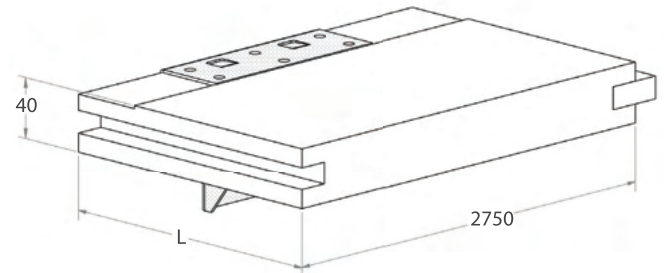
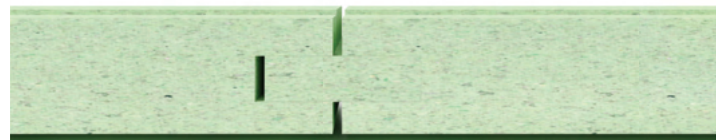

Stainless steel

Brackets made of

100 kg

Load point, from

2750 mm

Long elements, up to

280 mm

Maximum extension



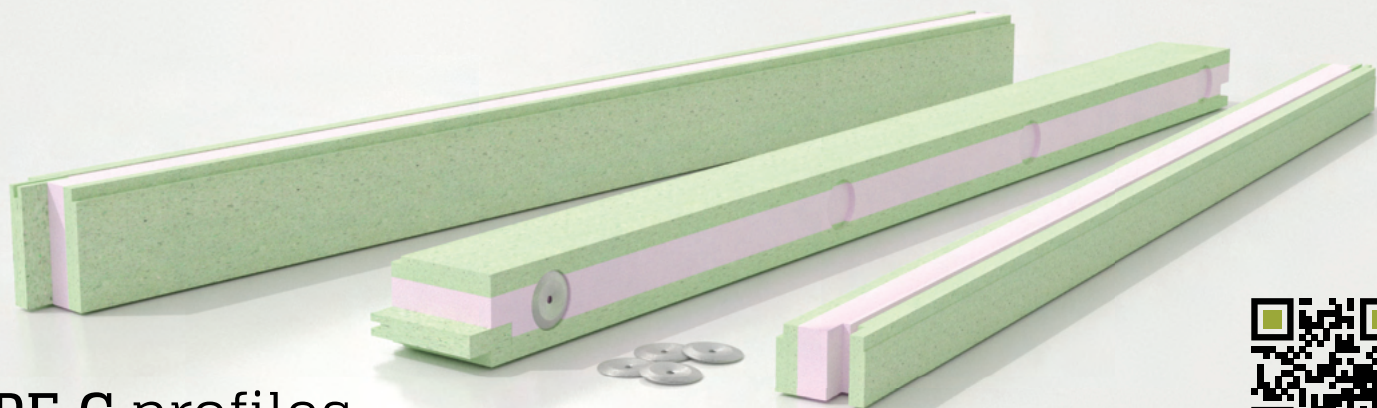

TYPE C profiles

Warmotech **TYPE C profiles** are used to lift window to the required height. These profiles come with a set of four washers and screws for which profiles have a milled mounting point. The profiles are made of extruded polystyrene foam (in the middle) for increased thermal insulation features and Warmotech board outer layers for additional strength. The routing of these profiles corresponds to the necessary window system.

Profiles are sold in units, standard unit length - 1150 mm.

50 or 60 mm

Standard width

1,05 W/m²K

U Value, from

30 to 220 mm

Standard height

150 kg

Load point, from

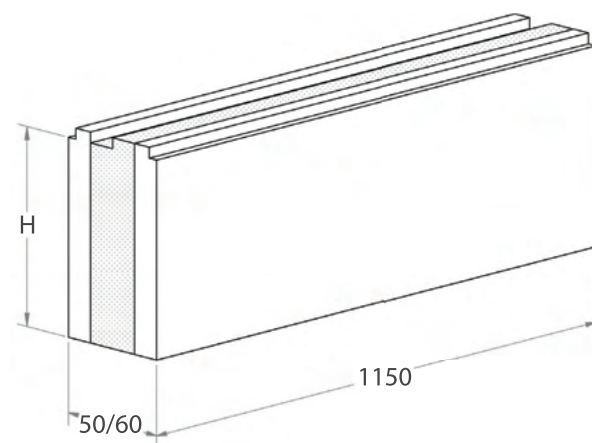
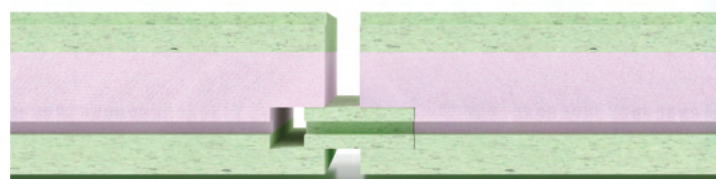



HSN profiles

Warmotech **HSN profiles** are made specifically for sliding door systems. They are used to lift the windows (HS systems) from the plinth to the required height. The profiles consist of multiple layers of extruded polystyrene foam and Warmotech panels. XPS layers reduce overall profile weight and increase thermal insulation properties. Layers of Warmotech board increase profile strength and rigidity. The routing of these profiles corresponds to the necessary window system. Profiles are sold in units, standard unit length - 1150 mm.

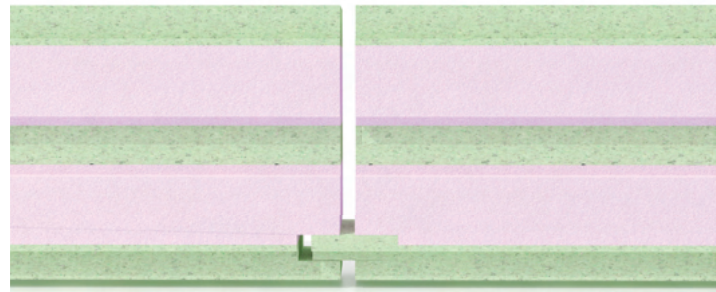

40 - 260 mm

Standard height

0,34 W/m²K

U value, from

140/160/180 mm

Standard width

200 kg

Load point, from

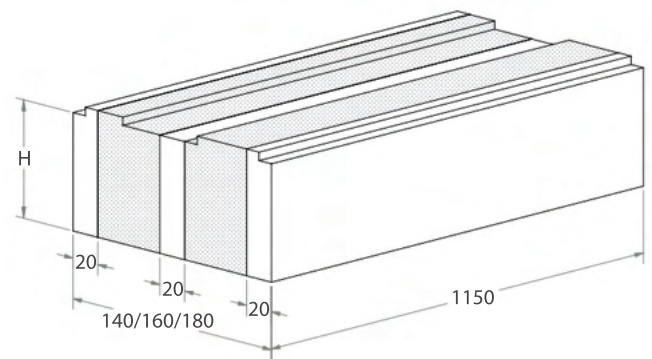



TYPE PA profiles

Warmotech **PA type profiles** are made of solid Warmotech material and are available in various dimensions. Used for the installation of wooden windows or extremely heavy structures. Also used in aluminum constructions, concrete industry and other fields.

Profiles are sold in units, standard unit length - 1150 mm or 2750 mm. On request, additional waste-free joint are possible.

10 - 100 mm
Standard thickness

2750 mm
Long elements, up to

10 - 500 mm
Standard width

≥ 7,1 MPa
Compressive strength

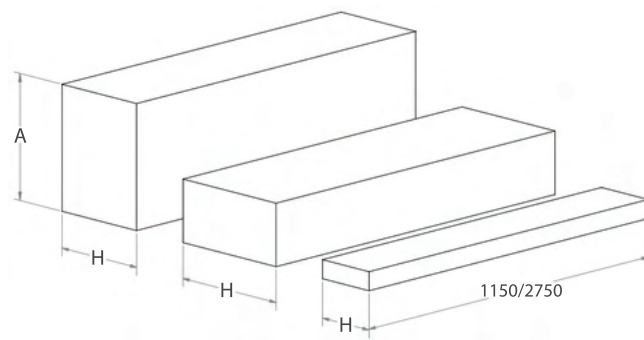



TYPE PA FR profiles

Warmotech **PA FR profiles** are used for lifting the window to the required height or floor level. The profile is rigid – made of a solid one-piece layer of Warmotech material. The top part of profile is routed according to window profiles. This tight connection ensures good thermal insulation properties. Profiles are sold in units, standard unit length – 1150 mm.



~550 kg/m³
Density

50 or 60 mm
Standard width

10 - 500 mm
Standard height

≥ 7,1 MPa
Compressive strength

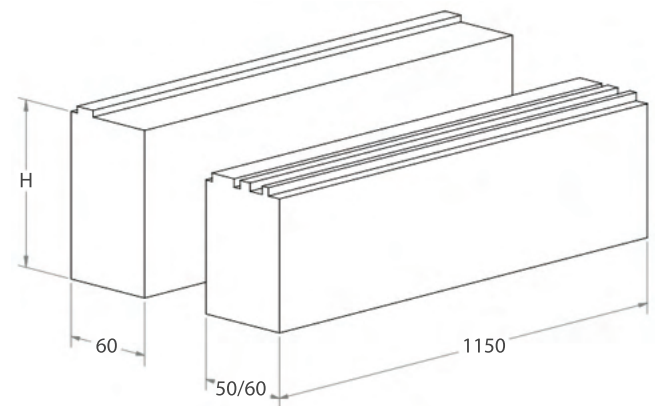

MULTI-LAYER elements

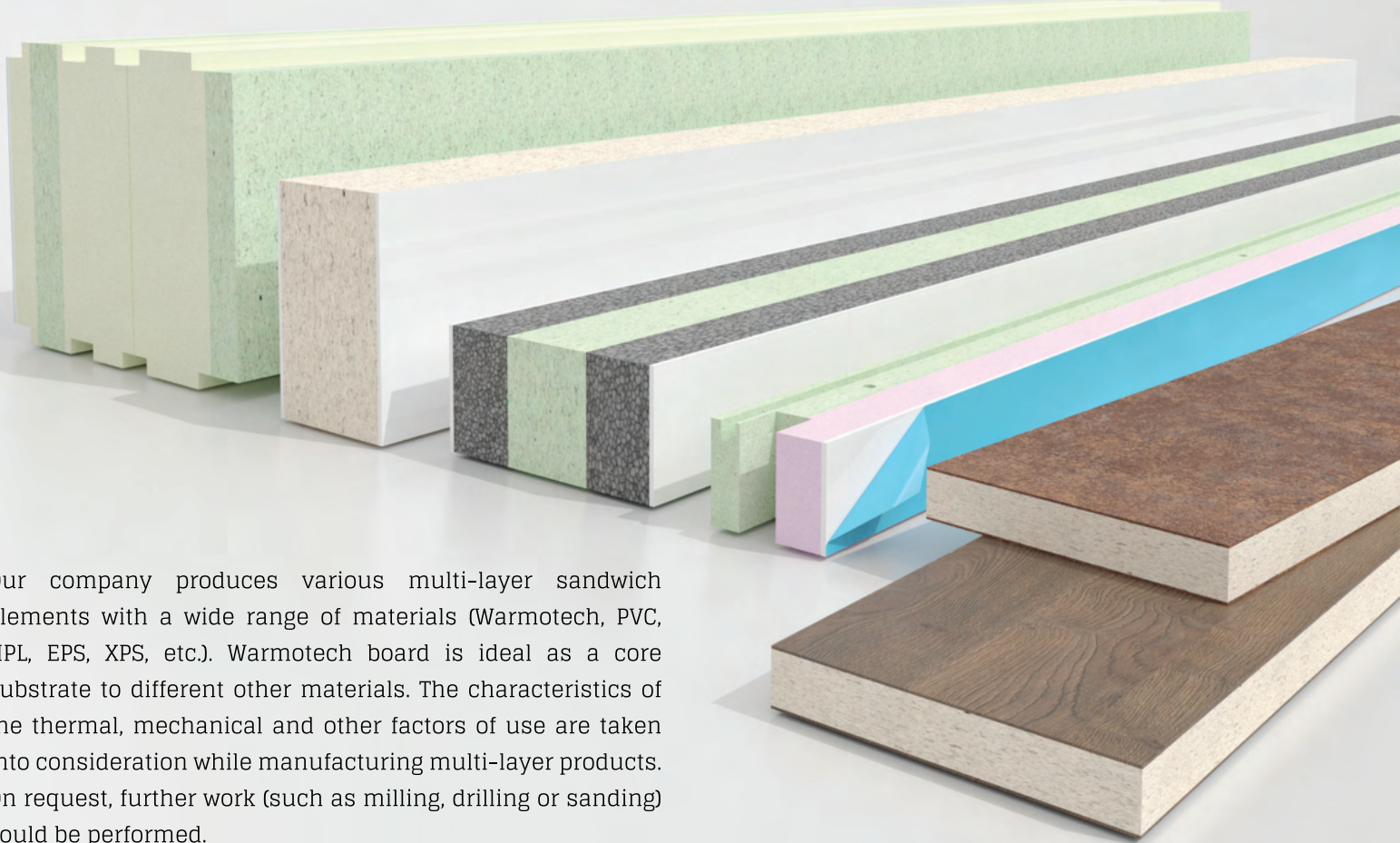

Our company produces various multi-layer sandwich elements with a wide range of materials (Warmotech, PVC, HPL, EPS, XPS, etc.). Warmotech board is ideal as a core substrate to different other materials. The characteristics of the thermal, mechanical and other factors of use are taken into consideration while manufacturing multi-layer products. On request, further work (such as milling, drilling or sanding) could be performed.

PVC

Polyvinyl chloride

XPS / EPS

Extruded / expanded polystyrene foam

HPL

High pressure laminate



W- core panels

w-core®



High pressure laminate (HPL) coatings are applied to a Warmotech board to create the laminated panel known as **W-core**. This panel can replace the regular particle boards or other panels that do not meet today's requirements. It is the perfect choice for furnishings and decoration that require high resistance to water, mold and rot. **W-core** is an eco-friendly material. The middle layer of the product is made from recycled polyurethane foam and is formaldehyde-free.

≤ 1,0 %

Thickness swelling

Water resistance

Suitable for high humidity and wet environments

10 - 60 mm

Thickness range

1150 x 2800 / 1220 x 3020 / 1220 x 3600

Standard panel formats

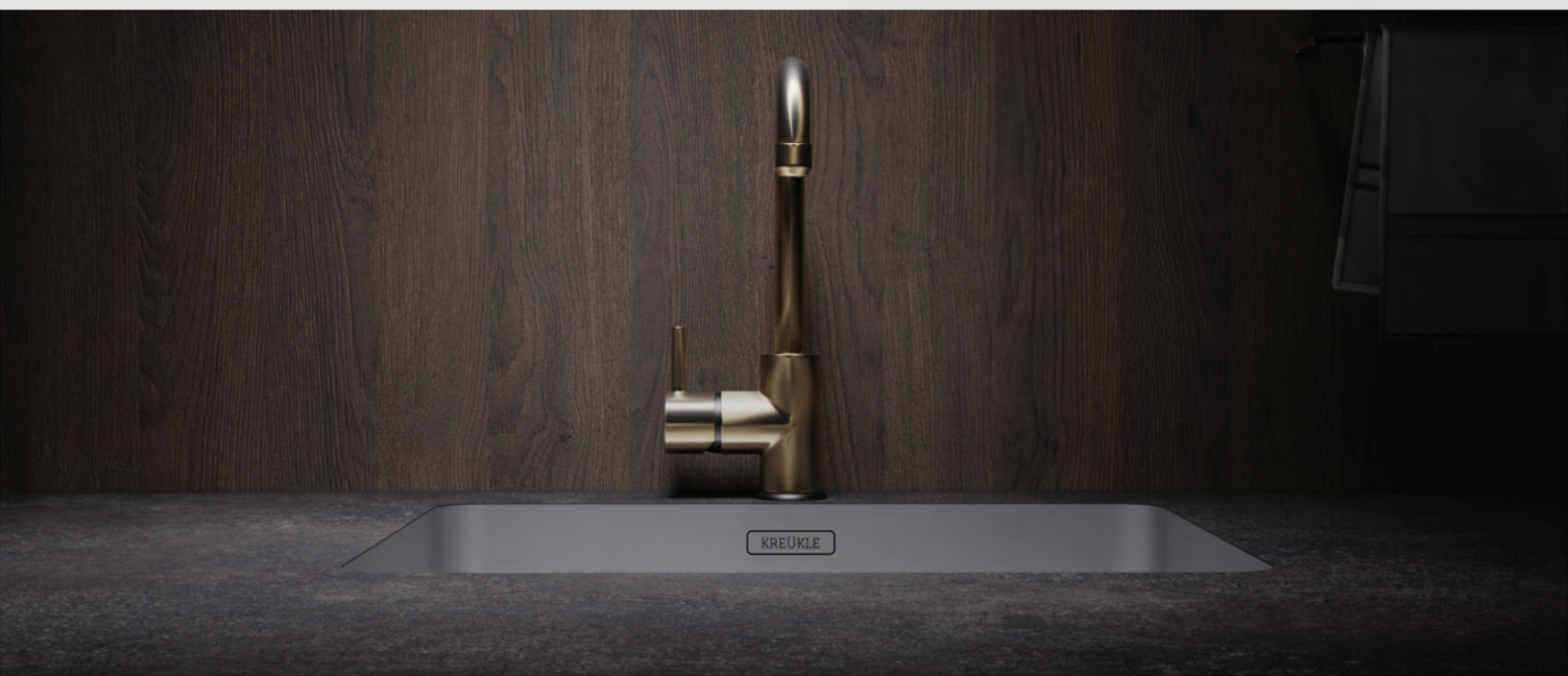



UAB ANDERUS
R. Kalantos str. 49, Kaunas
Production site - Elektrėnų str. 16, Kaunas
Lithuania
Tel. +370 662 30008
info@warmotech.lt
www.warmotech.lt

warmotech.lt

Rigid materials - flexible solutions